

DETAIL A

Pin Brake Washer(6) to Drive Screw(20) with Roll Pin(7).

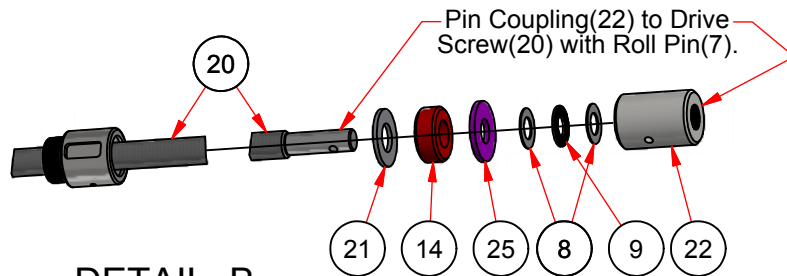

DETAIL B

Pin Coupling(22) to Drive Screw(20) with Roll Pin(7).

DETAIL C

- NOTES: 1. When assembling, orientate Items 6, 10, 12, 18, and 19, as shown.
 2. Install Locknut(15) with offset set screw holes closest to the Ballnut Bracket(17).
 3. Apply grease to Roller Bearing inside Bearing Retainer(12).
 4. Apply grease to Thrust Bearing(9) at three locations.
 5. Apply machine oil to the Ballnut(19) and Drive Screw(20).
 6. Center Brake Cap(1) on the Bearing Retainer(12) before tightening the 1/4-20NC Bolt(23) and Nuts(24).

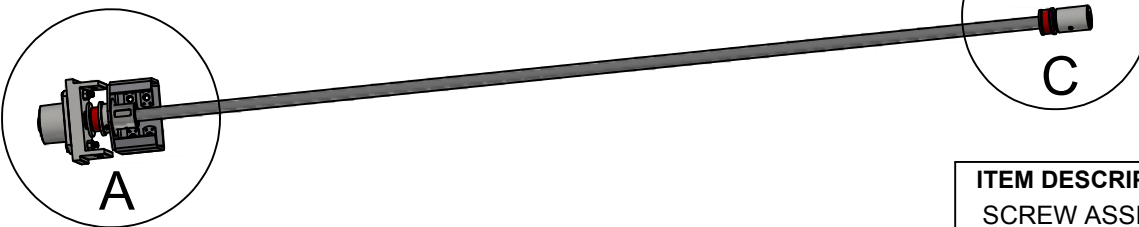

PARTS LIST

ITEM	QTY	PART No.	DESCRIPTION
1	1	181450A	BRAKE CAP LV-7
2	4	050840A	WASHER THRUST BRONZE .060
3	1	050140A	WASHER THRUST STEEL 1/2".090
4	1	050940B	WASHER BRAKE TOP
5	1	050800C	BRAKE SPRING
6	1	050820F	WASHER TOP BRAKE DRIVE
7	2	051680A	ROLL PIN SPIROL 3/16"x 1 1/8"
8	4	050810A	WASHER THRUST STEEL 1/2"x .030
9	3	050120A	BEARING THRUST STEEL
10	1	050850B	WASHER BOTTOM BRAKE DRIVE
11	3	050920A	WASHER THRUST STEEL 1/2"x .060
12	1	310070C	BEARING RETAINER ASSEMBLY LS
13	2	050040A	WASHER 5/8"PLATE ZINC
14	2	100700A	URETHANE BUMPER 1/2"L x 5/8"ID
15	1	082090A	BALLNUT LOCKNUT M26 x 1.5P
16	2	050550B	SET SCREW 1/4-20NC x 5/16
17	1	380250B	BALLNUT BRACKET LIFTGATE PF
18	1	080830A	WASHER DISC SPRING M26
19	1	080170A	BALLNUT METRIC (5/8"Version)
20	1	080157A	DRIVE SCREW 15.875mm x 1395mm
21	1	051850B	WASHER 5/8 SAE ZINC
22	1	300840A	COUPLING PAINT FINAL
23	2	050640A	BOLT 1/4-20NC x 1 1/2"HH GR5 ZINC
24	2	050610A	NUT 1/4-20 RING LOCK ZINC
25	1	055640A	WASHER 1/2"PLATE 1 3/8"LS
26	1	052200A	PLUG NYLON BLACK 1/2"HOLE

ITEM DESCRIPTION

SCREW ASSEMBLY LV-7

DATE:

2/13/19

DRN BY: BK

DATE:

APP BY:

C

ECN 1458-09

UNLESS OTHERWISE SPECIFIED:
 DIMENSIONS ARE IN INCHES
 TOLERANCES: ± 1/32, ANG. ± 1 Deg., HOLES ± .005
 DO NOT SCALE DRAWING, IF IN DOUBT ASK

LTR

REVISION DESCRIPTION

DATE

LP INTERNATIONAL INC.

ITEM NUMBER:

388017C